

**OPERATION**

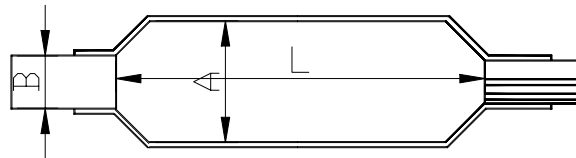

- Heat Shrinkable Sleeve
- Metal Canister
- Channels with under clip
- Branch off kit
- Shield Continuity wire
- Abrasive strip
- Cleaning tissue
- Aluminum foil
- Installation procedure

**Sizing / ordering information**  
(Dimensions in mm)



Description	Max splice bundle Diameter (A)	Min cable Diameter (B)	Nominal sheath Opening (L)
RSBF 250 32/10-250	32	10	250
RSBF 250 42/15-300	42	15	300
RSBF 250 50/18-400	50	18	400
RSBF 250 62/22-350	62	22	350
RSBF 250 62/22-500	62	22	500
RSBF 250 75/25-500	75	25	500
RSBF 250 92/30-500	92	30	500
RSBF 250 100/35-500	100	35	500
RSBF 250 122/38-500	122	38	500
RSBF 250 160/55-500	160	55	500

**BOKT KIT CONTENT**

- Branch off clip
- Cleaning tissue
- Tie wrap
- shield continuity clip + connector
- aluminum foil





Prepared cables, cut and remove cable sheath



Abrade the cable, wrap several layers of PVC tape over cable, Strain the end cable



Attach shield continuity wire to cable sheath with clip.



Center the metal canister over splice, Seal canister in right place with aluminum foil strip



Tightly wrap one half-lapped over canister with adhesive tape



Clean cable sheath at least 100 mm from canister with tissue



Abrade the cable sheath circumferentially, on the cleaned area with the abrasive strip



Place a mark on the cable just outside the edge of the sleeve



Wrapping aluminum foil strip over mark 10mm



Flame brush cable



Installing shrinkable sleeve, line sleeve up with mark on cable



Slide on channel



Install branch clip slipping clip over sleeve as Far as possible



Continue heating evenly around sleeve from center to end until entire sleeve is recovered



Tap channel down to conform to cable



Strain cables with tie wrap

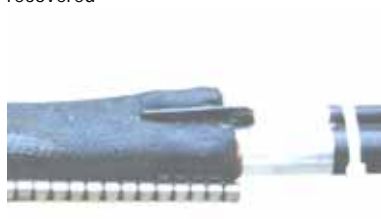

Continue heating until melted red adhesive is visible from the end.



Operation Completely